

ifau
Dresdener Str. 26
D-10999 Berlin
+49 (30) 27560453
ifau@berlin.heimat.de

Chinafrika
UABB
Bi-City Biennale of Urbanism\Architecture 17
Shenzhen

04/12/2017
Floorplan - detailed design
Building A3, 2nd floor, room 20
scale 1:100
(A3 print)

1.) Accesses gates and windows light and sound-absorbing
All accesses gates double screened and windows single screened with flame resistant (B1) black or grey stage molton to blackout the exhibition space

2.) Floor light and sound-absorbing
Floor carpeted with black or grey exhibition wall-to-wall-carpeting. Cutouts of the carpet according to display tables, big poster and access gates

3.) 2 to 3 Displays / tables
Displays / tables on couch-table height (40 cm), width = 50 cm with set black steel table legs painted black.
Table top out of plywood panels (24 mm) as shown in the floorplan. Tabletops mounted with cutout exhibition carpet, fixed with double-sided adhesive tape, edges painted black or grey

4.) 20 small stools (to be sampled)
(diameter: ca. 30 - 35 cm, height: 35 - 40 cm)

5.) LED-monitors 55"
8 to 10 x LED-monitors to be leant against the walls or display tables with headphones according curatorial instruction

6.) LED-monitors 49"
3 LED-monitors horizontally hung from the ceiling to light the display tables

7.) Poster
Cut out in the carpet, poster print on the floor

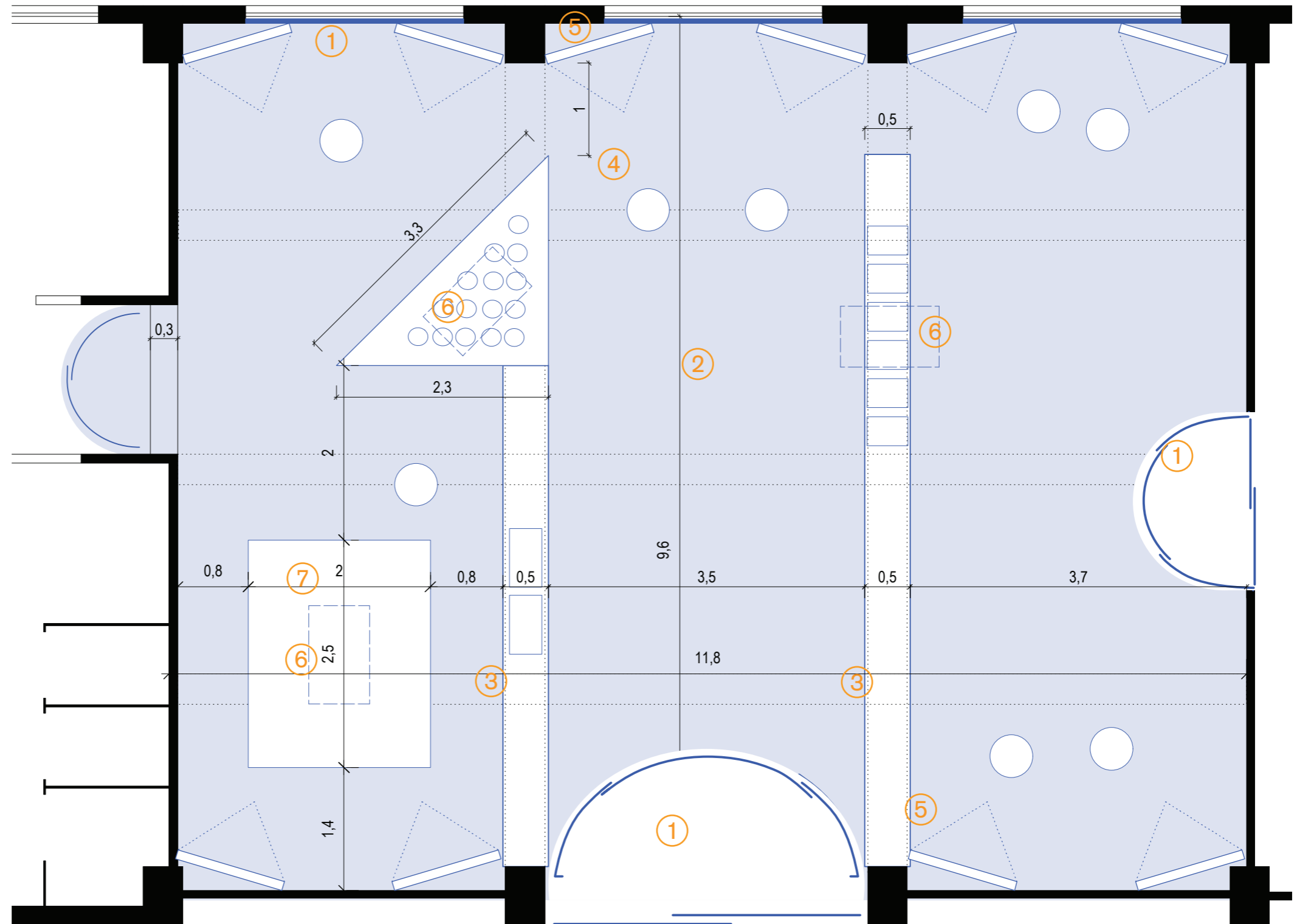

ifau
Dresdener Str. 26
D-10999 Berlin
+49 (30) 27560453
ifau@berlin.heimat.de

Chinafrika
UABB
Bi-City Biennale of Urbanism\Architecture 17
Shenzhen

04/12/2017
Axonometry - detailed design
Building A3, 2nd floor, room 20

(A3 print)

